

14th International Conference  
Mobility and Transport for Elderly and Disabled Persons  
Lisbon, Portugal, 28-31 July 2015



TRANSED 2015  
LISBOA

# DRIVING PERFORMANCE PROFILES OF DRIVERS WITH PARKINSON'S DISEASE

Dimosthenis Pavlou<sup>1</sup>, Eleonora Papadimitriou<sup>1</sup>, Sophia Vardaki<sup>1</sup>, Panagiotis Papantoniou<sup>1</sup>,  
Nikolaos Andronas<sup>2</sup>, George Yannis<sup>1</sup>, John Golias<sup>1</sup> and Sokratis G. Papageorgiou<sup>2</sup>



<sup>1</sup>Department of Transportation Planning and Engineering, National Technical University of Athens, Athens, Greece

<sup>2</sup>University of Athens, 2nd Department of Neurology, "Attikon" University General Hospital, Athens, Greece

# OVERVIEW



TRANSED 2015  
LISBOA

- Background
- Objectives
- Experiment Design
- Data and analysis methods
- Results
- Conclusions – Discussion



# BACKGROUND 1/2



TRANSED 2015  
LISBOA

- Driving requires the ability to **receive** sensory information, **process** the information, and to **make proper, timely judgments** and responses
- Various motor, visual, cognitive and perceptual deficits can affect the ability to drive and **lead to reduced driver fitness and increased crash risk**
- More specifically, diseases **affecting a person's brain functioning** (e.g. Parkinson's disease) may significantly impair the person's driving ability



# BACKGROUND 2/2



TRANSED 2015  
LISBOA

- Parameters associated with driving performance are reaction time, visual attention, speed of perception and processing, and general cognitive and executive functions
- These parameters show **considerable decline** with age and especially at the **presence of Parkinson's disease** lead to deterioration in driving performance and are associated with the **increased probability of accident involvement**



# OBJECTIVE OF THE RESEARCH



TRANSED 2015  
LISBOA

The objective of this research is to **present and analyze the driving performance profiles of drivers with Parkinson's disease (PD)**, on the basis of a **driving simulator experiment**, in which healthy and PD participants drive in different driving scenarios



# EXPERIMENT DESIGN



TRANSED 2015  
LISBOA

- Distract research project
- Neurologists - Medical/neurological assessment:
  - administration of a full clinical medical, ophthalmological and neurological evaluation
- Neuropsychologists - Neuropsychological assessment:
  - administration of a series of neuropsychological tests and psychological - behavioural questionnaires to the participants which cover a large spectrum of Cognitive Functions
- Transportation Engineers - Driving at the simulator

distrACT

<http://www.nrso.ntua.gr/distract/>



# “DRIVING AT THE SIMULATOR”



TRANSED 2015  
LISBOA

- Concerns the **assessment of driving behaviour** by means of programming of a set of driving tasks for different driving scenarios
- **Quarter-cab driving simulator** manufactured by the FOERST Company
- **3 LCD wide screens** 42" (full HD: 1920x1080pixels)
  - total field of view 170 degrees
- **Validated** against a real world environment
- At first, **one practice drive** (usually 10-15 minutes)



# RURAL SESSION



TRANSED 2015  
LISBOA

- 2.1 km long, single carriageway, 3m lane width, zero gradient, mild horizontal curves
- 2 traffic scenarios examined:
  - Low traffic conditions ( $Q_L=300$  vehicles/hour)
  - High traffic conditions ( $Q_H=600$  vehicles/hour)
- 2 unexpected incidents are scheduled to occur:
  - sudden appearance of an animal (deer or donkey) on the roadway
- Analyzed by Generalized Linear Model (GLM)





# MOTORWAY SESSION



TRANSED 2015  
LISBOA

## Motorway scenario

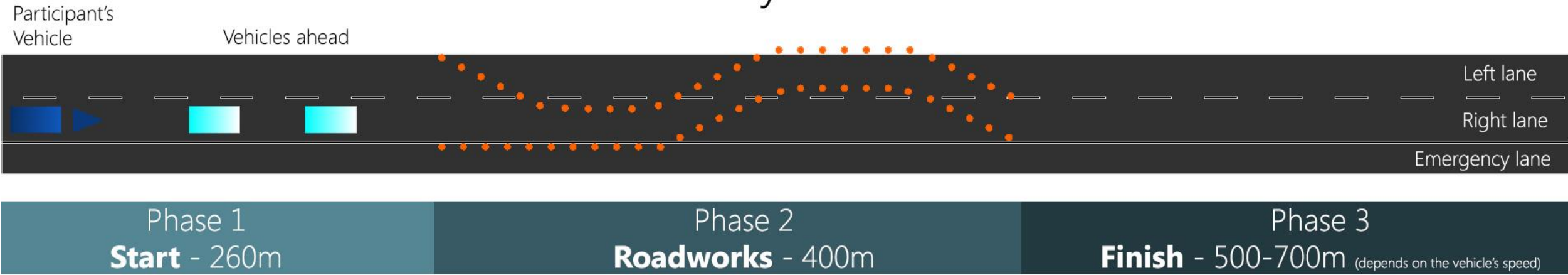

- Firstly a period of **low-demand driving** (right lane, straight ahead)
- Afterwards, the subject is negotiating the **road work segment**
  - All drivers made a **double lane change** that involved driving through a road work section containing large blocks (barriers) on each side of the road, causing the road to **progressively narrow** (1:20 taper ratio; lane width 3m)



# DATA AND ANALYSIS METHODS



TRANSED 2015  
LISBOA

## Sample size

- 62 participants (36 males)
- 41 "healthy controls" (64.1y.o.±8.1)
- 21 PD patients (65.3y.o.±6.9)



## Driving performance measures

- Mean speed
- Time Headway
- Lateral position (+variability)
- Wheel steering angle (+variability)
- Reaction time at unexpected incident
- Accident probability (inside the work segment)



# RESULTS - SPEED AND HEADWAY



TRANSED 2015 LISBOA

Parameter Estimates	B	Std. Error	95% Wald Confidence Interval		Hypothesis Test		
			Lower	Upper	Wald Chi-Square	df	Sig.
(Intercept)	42,78	1,05	40,71	44,84	1651,68	1	0,000
PD Q <sub>L</sub>	<b>-6,36</b>	2,05	-10,38	-2,35	9,64	1	<b>0,002</b>
PD Q <sub>H</sub>	<b>-8,72</b>	2,05	-12,74	-4,71	18,12	1	<b>0,000</b>
Controls Q <sub>L</sub>	2,61	1,52	-0,37	5,59	2,95	1	0,086
Controls Q <sub>H</sub>	0 <sup>a</sup>						
(Scale)	58,72 <sup>b</sup>	7,02	46,45	74,22			
Dependent Variable: Speed Model: (Intercept), ID							
a. Set to zero because this parameter is redundant. b. Maximum likelihood estimate.							

Parameter Estimates	B	Std. Error	95% Wald Confidence Interval		Hypothesis Test		
			Lower	Upper	Wald Chi-Square	df	Sig.
(Intercept)	28,58	3,86	21,02	36,15	54,87	1	0,000
PD Q <sub>L</sub>	<b>72,01</b>	7,51	57,29	86,73	91,89	1	<b>0,000</b>
PD Q <sub>H</sub>	<b>26,72</b>	7,51	12,00	41,45	12,66	1	<b>0,000</b>
Controls Q <sub>L</sub>	<b>20,75</b>	5,57	9,84	31,67	13,90	1	<b>0,000</b>
Controls Q <sub>H</sub>	0 <sup>a</sup>						
(Scale)	789,2 <sup>b</sup>	94,3279	624,38	997,53			
Dependent Variable: Time Headway Model: (Intercept), ID							
a. Set to zero because this parameter is redundant. b. Maximum likelihood estimate.							

- PD drivers drive at significant slower speeds (**20% lower speed overall**)
- The traffic volume seems to have the **same effect** on all participants

- PD drivers keep statistically significant **larger time headways**
- The higher traffic volume seems to **affect more the PD group**



# RESULTS - LATERAL POSITION



TRANSED 2015 LISBOA

Parameter Estimates	B	Std. Error	95% Wald Confidence Interval		Hypothesis Test		
			Lower	Upper	Wald Chi-Square	df	Sig.
(Intercept)	1,60	0,02	1,56	1,64	7637,80	1	0,000
PD Q <sub>L</sub>	<b>-0,16</b>	0,04	-0,23	-0,09	19,24	1	<b>0,000</b>
PD Q <sub>H</sub>	-0,06	0,04	-0,13	0,01	2,91	1	0,088
Controls Q <sub>L</sub>	<b>-0,11</b>	0,03	-0,17	-0,06	18,34	1	<b>0,000</b>
Controls Q <sub>H</sub>	0 <sup>a</sup>						
(Scale)	0,018 <sup>b</sup>	0,002	0,014	0,022			
Dependent Variable: Lateral Position Model: (Intercept), ID							
a. Set to zero because this parameter is redundant. b. Maximum likelihood estimate.							

Parameter Estimates	B	Std. Error	95% Wald Confidence Interval		Hypothesis Test		
			Lower	Upper	Wald Chi-Square	df	Sig.
(Intercept)	0,26	0,01	0,24	0,27	949,44	1	0,000
PD Q <sub>L</sub>	<b>0,05</b>	0,02	0,01	0,08	8,06	1	<b>0,005</b>
PD Q <sub>H</sub>	0,00	0,02	-0,03	0,04	0,18	1	0,673
Controls Q <sub>L</sub>	<b>0,03</b>	0,01	0,01	0,05	5,48	1	<b>0,019</b>
Controls Q <sub>H</sub>	0 <sup>a</sup>						
(Scale)	0,004 <sup>b</sup>	0,0004	0,003	0,005			
Dependent Variable: Lateral Position Variability Model: (Intercept), ID							
a. Set to zero because this parameter is redundant. b. Maximum likelihood estimate.							

- PD drivers tend to drive **“to the left”** at low traffic volume
- High traffic volume leads to **more conservative driving**

- PD drivers have **difficulty in positioning the vehicle** inside the lane in low traffic volume



# RESULTS - STEERING ANGLE



TRANSED 2015 LISBOA

Parameter Estimates	B	Std. Error	95% Wald Confidence Interval		Hypothesis Test		
			Lower	Upper	Wald Chi-Square	df	Sig.
(Intercept)	-2,03	0,09	-2,21	-1,85	498,58	1	0,000
PD Q <sub>L</sub>	<b>0,48</b>	0,18	0,13	0,83	7,36	1	<b>0,007</b>
PD Q <sub>H</sub>	0,18	0,18	-0,16	0,53	1,07	1	0,300
Controls Q <sub>L</sub>	0,22	0,13	-0,04	0,48	2,77	1	0,096
Controls Q <sub>H</sub>	0 <sup>a</sup>						
(Scale)	0,44 <sup>b</sup>	0,05	0,35	0,55			
Dependent Variable: Steering Angle Model: (Intercept), ID							
a. Set to zero because this parameter is redundant. b. Maximum likelihood estimate.							

Parameter Estimates	B	Std. Error	95% Wald Confidence Interval		Hypothesis Test		
			Lower	Upper	Wald Chi-Square	df	Sig.
(Intercept)	17,02	0,250	16,53	17,51	4619,81	1	0,000
PD Q <sub>L</sub>	<b>1,41</b>	0,487	0,46	2,37	8,39	1	<b>0,004</b>
PD Q <sub>H</sub>	<b>0,92</b>	0,487	0,04	1,87	3,53	1	<b>0,050</b>
Controls Q <sub>L</sub>	0,40	0,361	-0,31	1,10	1,19	1	0,275
Controls Q <sub>H</sub>	0 <sup>a</sup>				-1,87		
(Scale)	3,32 <sup>b</sup>	,397	2,63	4,20			
Dependent Variable: Steering Angle Variability Model: (Intercept), ID							
a. Set to zero because this parameter is redundant. b. Maximum likelihood estimate.							

- PD participants in low traffic volume tend to **turn the wheel "to the left"** compared with the control group

- PD participants have **higher variability in wheeling angle** compared with the control group in both traffic volumes



# RESULTS - REACTION TIME

Parameter Estimates	B	Std. Error	95% Wald Confidence Interval		Hypothesis Test		
			Lower	Upper	Wald Chi-Square	df	Sig.
(Intercept)	1719,90	76,17	1570,61	1869,19	509,85	1	0,000
PD Q <sub>L</sub>	349,58	151,28	53,08	646,08	5,34	1	,021
PD Q <sub>H</sub>	641,47	151,28	344,97	937,96	17,98	1	,000
Controls Q <sub>L</sub>	-130,45	109,90	-345,84	84,95	1,41	1	0,235
Controls Q <sub>H</sub>	0 <sup>a</sup>						
(Scale)	307497,66 <sup>b</sup>	37018,37	242867,38	389326,92			

Dependent Variable: Reaction Time  
Model: (Intercept), ID

a. Set to zero because this parameter is redundant. b. Maximum likelihood estimate.

- PD drivers have **statistically worse reaction times** in all traffic environments (**30% worse** reaction times overall)
- The **higher is the traffic volume** the worse is the reaction time for PD participants
- Traffic volume does not affect reaction time of the control group

# RESULTS - MOTORWAY SESSION



TRANSED 2015  
LISBOA

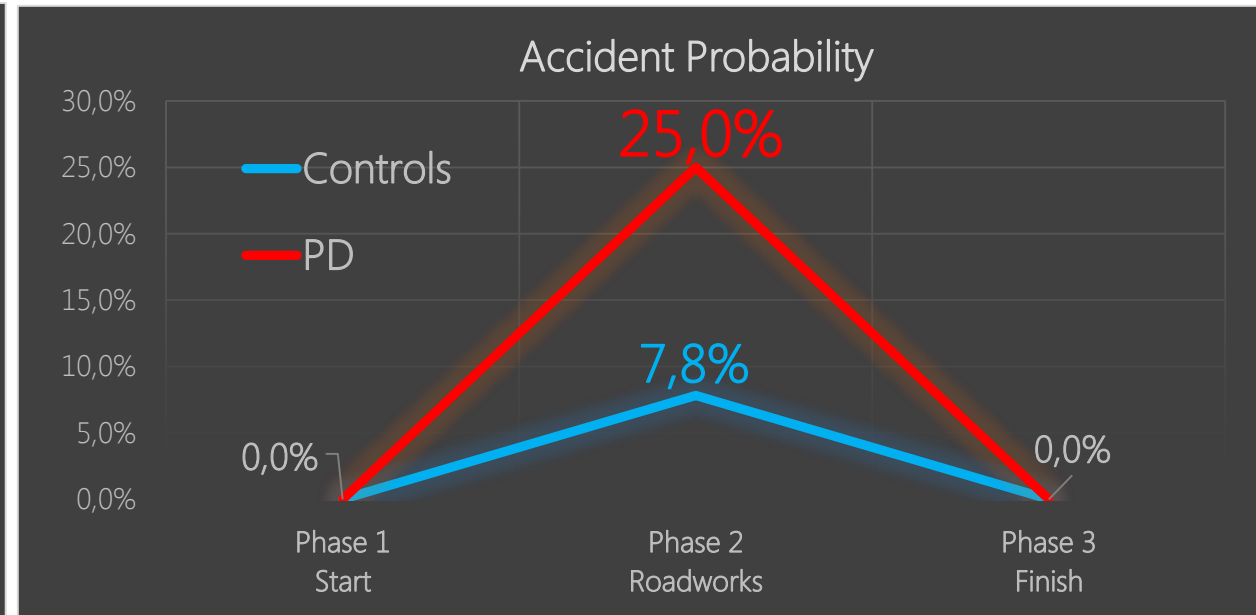
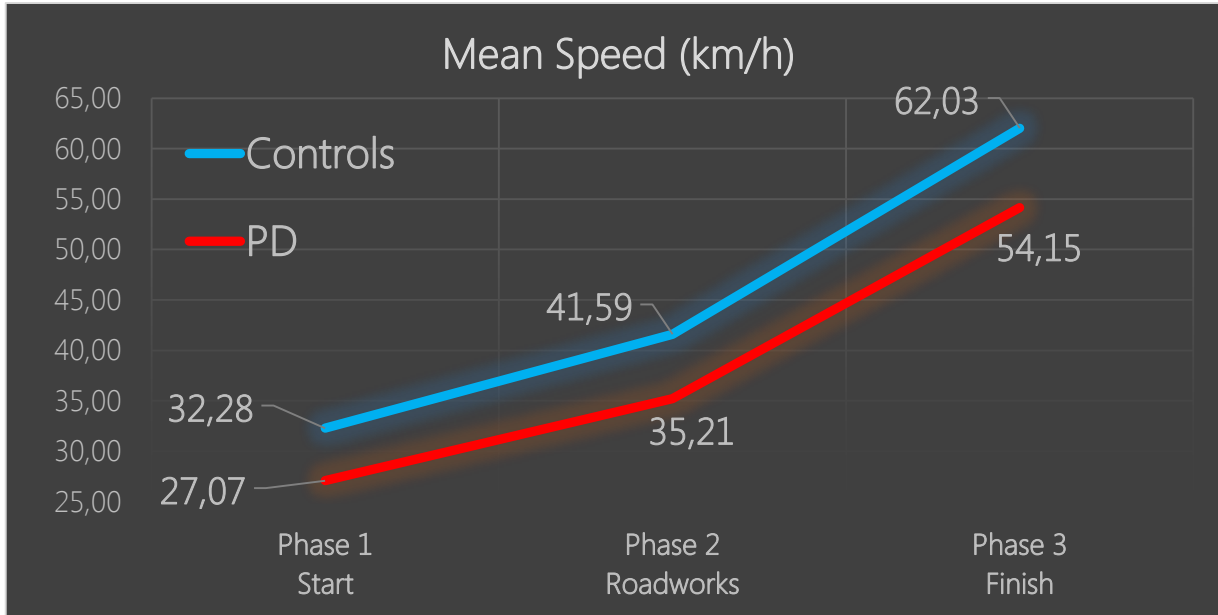

- Inside the work segment, although PD patients drive **15% lower** than control group, their accident probability is **3 times higher**



# CONCLUSIONS - DISCUSSION 1/2



TRANSED 2015  
LISBOA

**PD drivers** (compared to the control group) were found to:

- drive at significantly **lower speeds**
- keep **large headways**
- have significantly **worse reaction times** (even worse if the driving environment difficulty level increases)
- have **difficulties in positioning the vehicle** inside the lane
- tend to drive to **the left double borderline**
- have **3 times higher accident probability** inside a work-zone segment that demands a simple manoeuvre

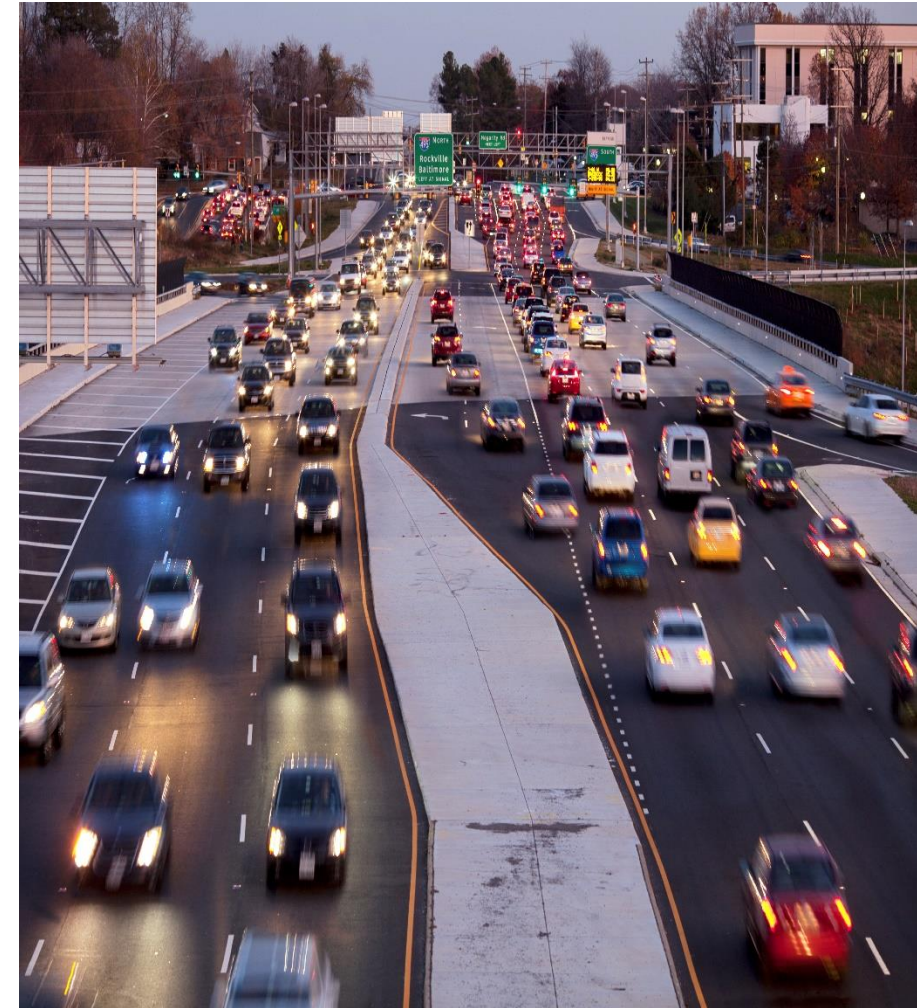



# CONCLUSIONS - DISCUSSION 2/2



TRANSED 2015  
LISBOA

- Overall, the **deterioration of the driving performance of PD patients is confirmed** and analyzed with mathematical models by the present study
- The results are to be considered within the **limited context of driving simulator studies** - driving performance is known to be more accurately and reliably estimated by means of on-road studies
- However, the relative effects of patients vs healthy drivers are known to be **quite identifiable** in simulator studies



14th International Conference  
Mobility and Transport for Elderly and Disabled Persons  
Lisbon, Portugal, 28-31 July 2015



TRANSED 2015  
LISBOA

# DRIVING PERFORMANCE PROFILES OF DRIVERS WITH PARKINSON'S DISEASE

Dimosthenis Pavlou<sup>1</sup>, Eleonora Papadimitriou<sup>1</sup>, Sophia Vardaki<sup>1</sup>, Panagiotis Papantoniou<sup>1</sup>,  
Nikolaos Andronas<sup>2</sup>, George Yannis<sup>1</sup>, John Golias<sup>1</sup> and Sokratis G. Papageorgiou<sup>2</sup>



<sup>1</sup>Department of Transportation Planning and Engineering, National Technical University of Athens, Athens, Greece

<sup>2</sup>University of Athens, 2nd Department of Neurology, "Attikon" University General Hospital, Athens, Greece